

# TYPE EV-0030

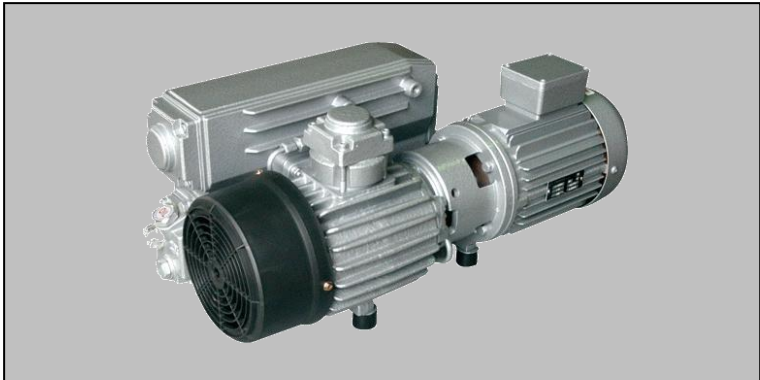

Pumping speed curve

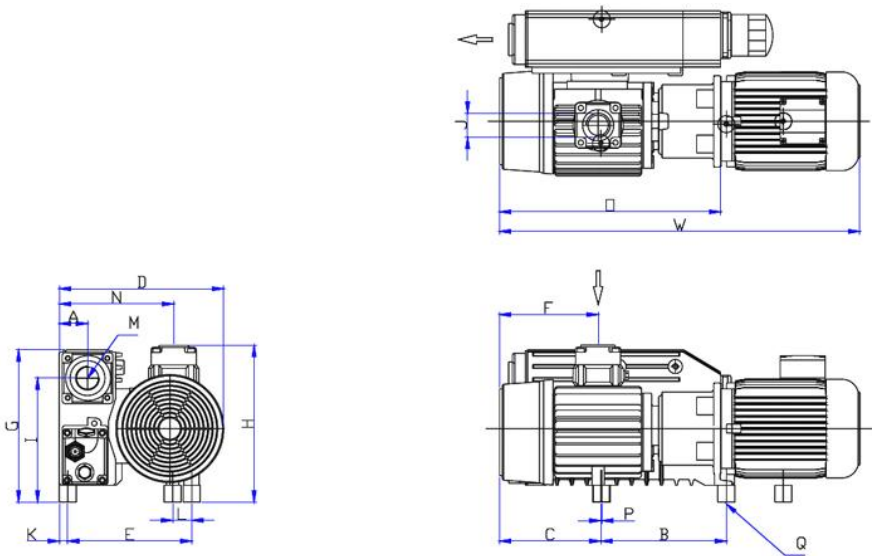
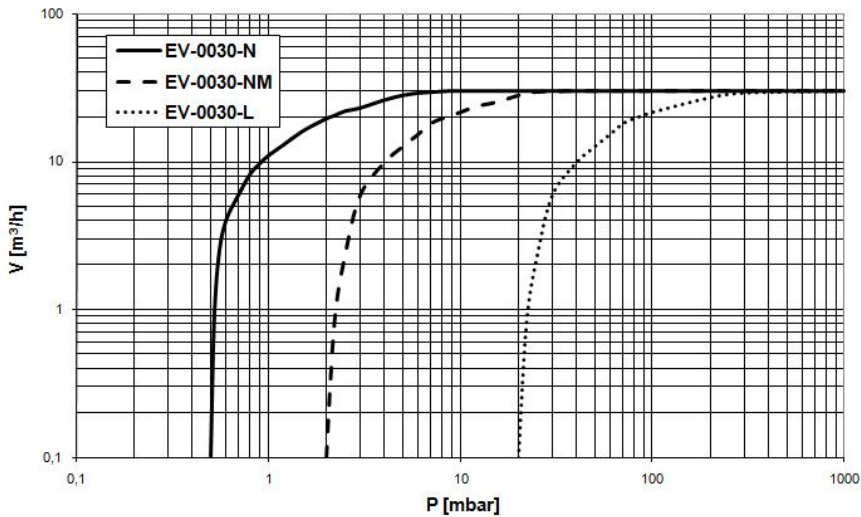

Dimensions	W	D	H	A	B	C	E	F	G	I	J	K	L	M	N	O	P	Q
EV-0030	590	290	280	50	187	155	181	150	270	220	G 1¼"	15	39	G 1¼"	203	342	1.5	3x M8

## TYPE EV-0030

Technical Data		TYPE EV-0030	
		50 Hz	60 Hz
Nominal displacement	m <sup>3</sup> /h	30	36
Ultimate pressure F type	mbar	0,5	0,5
Motor power	kW	1,1	1,1
Nominal speed	rpm	1450	1740
Noise level	dB(A)	64	67
Operating temperature	°C	76	76
Water vapor tolerance	mbar	40	40
Water vapor capacity	l/h	0,7	0,9
Oil capacity	ltr	1	1
Weight	kg	47	47
Admissible ambient temp.	°C	10 to 40	10 to 40
Connection Inlet	G(BSP)	1¼"	1¼"
Outlet	G(BSP)	1¼"	1¼"

Ordering Information		TYPE EV-0030	
		50 Hz	60 Hz
F version (0,5 mbar)			
Single phase motor			
230V, 50/60 Hz (IEC)		104.000	104.000
Three phase motor			
400V, 50Hz (IEC)		104.001	
400V, 60Hz (IEC)			104.002
Other Voltages/Frequencies		Upon request	
Filling with special oil		Upon request	
Exhaust filter cartridge		06120B	
Gasket set		06490	
Maintenance kit		06500	
Pump module		06900	
Inlet dust filter, paper cartridge		20800	

# TYPE EV-0040



Pumping speed curve

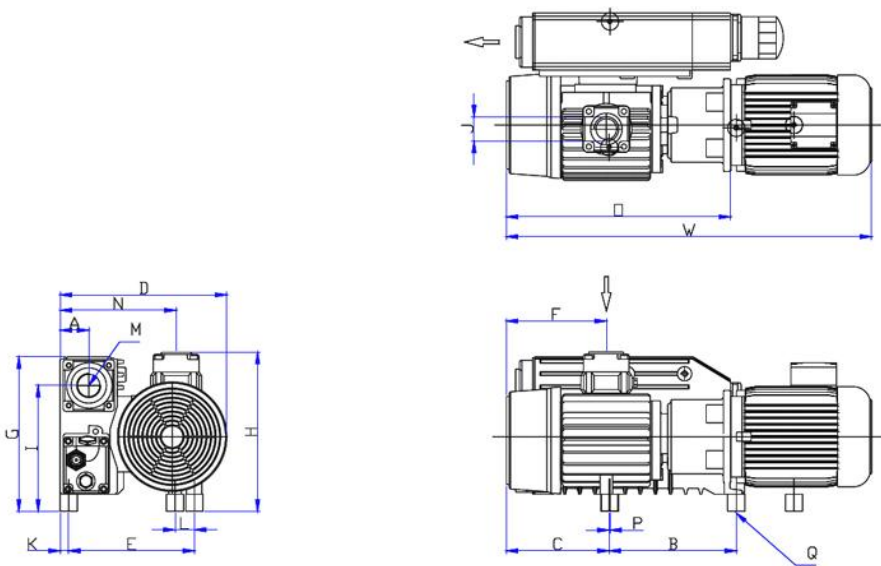
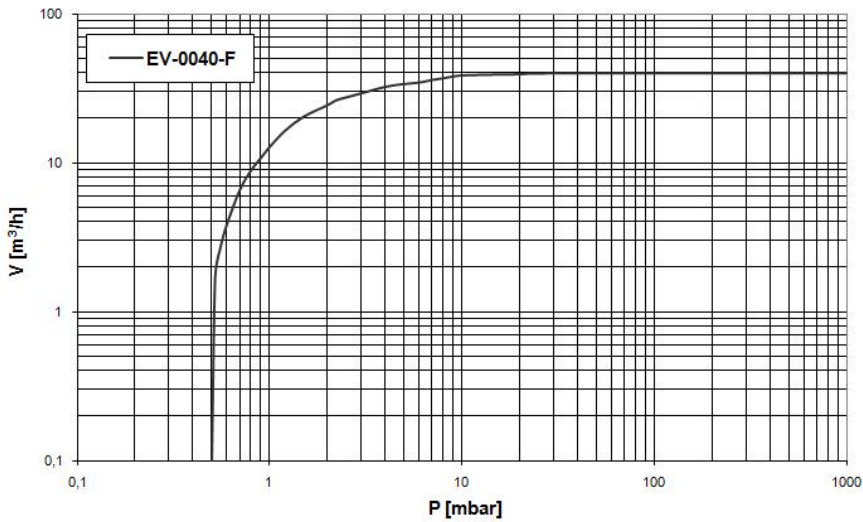

Dimensions	W	D	H	A	B	C	E	F	G	I	J	K	L	M	N	O	P	Q
EV-0040	630	290	280	50	223	180	220	175	270	220	G 1¼"	15	39	G 1¼"	203	392	1.5	3x M8

## TYPE EV-0040

Technical Data		TYPE EV-0040	
		50 Hz	60 Hz
Nominal displacement	m <sup>3</sup> /h	40	48
Ultimate pressure F type	mbar	0,5	0,5
Motor power	kW	1,1	2
Nominal speed	rpm	1450	1740
Noise level	dB(A)	64	67
Operating temperature	°C	78	78
Water vapor tolerance	mbar	40	40
Water vapor capacity	l/h	0,8	1,0
Oil capacity	ltr	1,4	1,4
Weight	kg	53	53
Admissible ambient temp.	°C	10 to 40	10 to 40
Connection Inlet	G(BSP)	1¼"	1¼"
Outlet	G(BSP)	1¼"	1¼"

Ordering Information		TYPE EV-0040	
		50 Hz	60 Hz
F version (0,5 mbar)			
Single phase motor			
230V, 50/60 Hz (IEC)		105.000	105.000
Three phase motor			
400V, 50Hz (IEC)		105.001	
400V, 60Hz (IEC)			105.002
Other Voltages/Frequencies		Upon request	
Filling with special oil		Upon request	
Exhaust filter cartridge		20120A	
Gasket set		08490	
Maintenance kit		08500	
Pump module		08900	
Inlet dust filter, paper cartridge		20800	

# TYPE EV-0065



Pumping speed curve

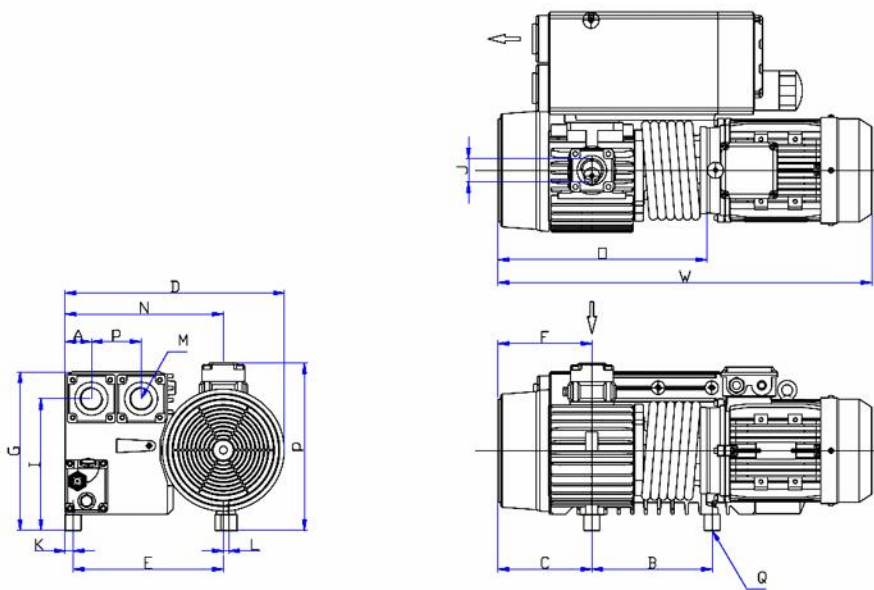
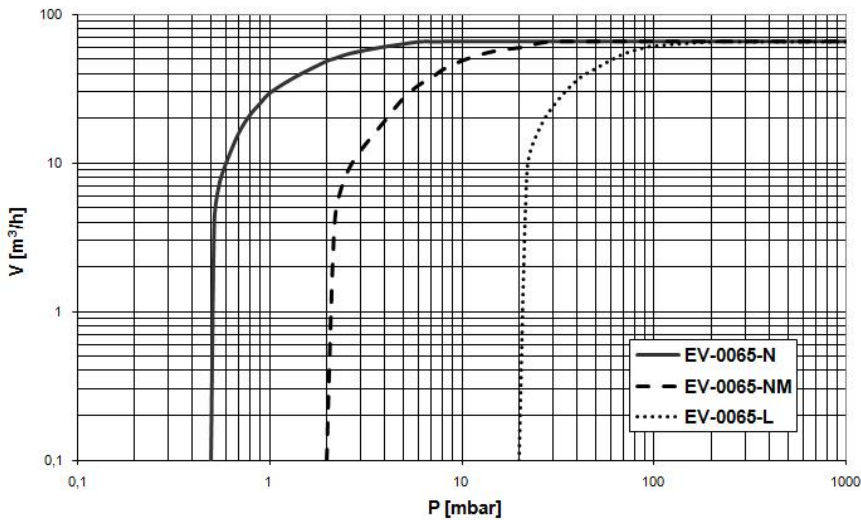

Dimensions	W	D	H	A	B	C	E	F	G	I	J	K	L	M	N	O	P	Q
EV-0065	650	410	313	50	200	145	295	145	296	246	G 1¼"	15	11	G 1¼"	295	340	313	3x M8

## TYPE EV-0065

Technical Data		TYPE EV-0065	
		50 Hz	60 Hz
Nominal displacement	m <sup>3</sup> /h	65	78
Ultimate pressure N type	mbar	< 0,5	< 0,5
NM type	mbar	< 2	< 2
L type	mbar	20	20
Motor power	kW	2,2	2,2
Nominal speed	rpm	1450	1740
Noise level	dB(A)	65	68
Operating temperature	°C	85	85
Water vapor tolerance	mbar	40	40
Water vapor capacity	l/h	1,6	1,8
Oil capacity	ltr	2	2
Weight	kg	66	66
Admissible ambient temp.	°C	10 to 40	10 to 40
Connection Inlet	G(BSP)	1¼"	1¼"
Outlet	G(BSP)	1¼"	1¼"

Ordering Information	TYPE EV-0065	
	50 Hz	60 Hz
<u>N version (0,5 mbar)</u> <b>Three phase motor</b> 400V, 50Hz (IEC) 400V, 60Hz (IEC)	106.001	106.002
<u>NM version (2 mbar)</u> <b>Three phase motor</b> 400V, 50Hz (IEC) 400V, 60Hz (IEC)	106.101	106.102
<u>L version (20 mbar)</u> <b>Three phase motor</b> 400V, 50Hz (IEC) 400V, 60Hz (IEC)	106.201	106.202
Other Voltages/Frequencies	Upon request	
Filling with special oil	Upon request	
Exhaust filter cartridge	20120A	
Gasket set	20490	
Maintenance kit	13500	
Pump module	13900	
Inlet dust filter, paper cartridge	20800	

# TYPE EV-0100



Pumping speed curve

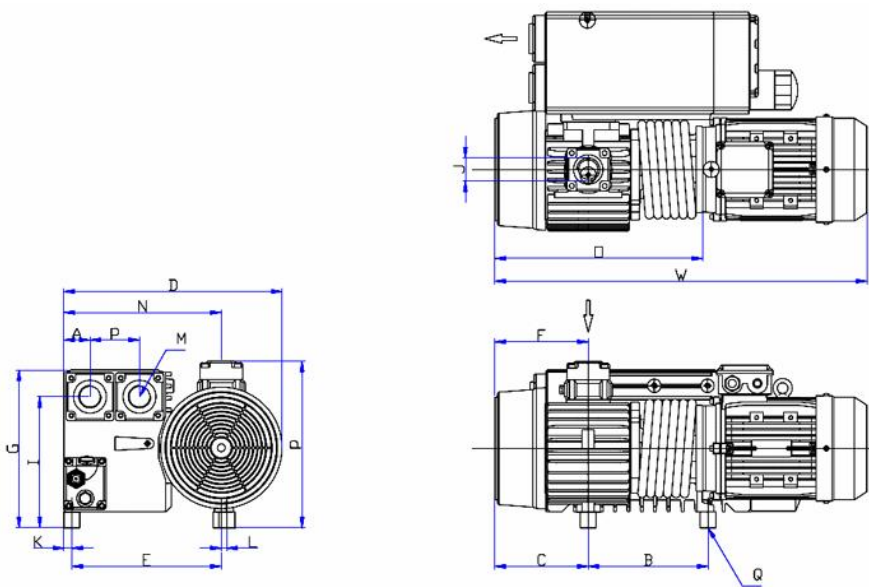
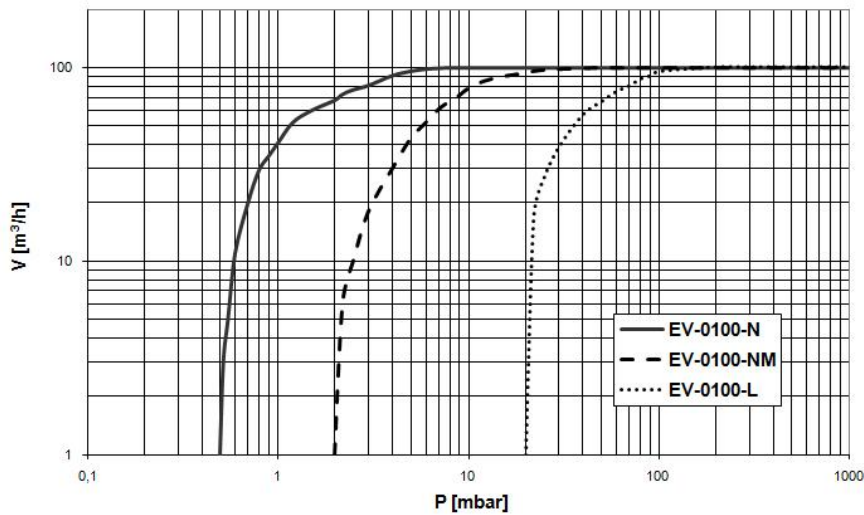

Dimensions	W	D	H	A	B	C	E	F	G	I	J	K	L	M	N	O	P	Q
EV-0100	700	410	313	50	225	175	295	175	296	246	G 1¼"	15	11	G 1¼"	295	390	313	3x M8

## TYPE EV-0100

Technical Data		TYPE EV-0100	
		50 Hz	60 Hz
Nominal displacement	m <sup>3</sup> /h	100	120
Ultimate pressure N type	mbar	< 0,5	< 0,5
NM type	mbar	< 2	< 2
L type	mbar	20	20
Motor power	kW	3,0	3,0
Nominal speed	rpm	1450	1740
Noise level	dB(A)	65	68
Operating temperature	°C	85	85
Water vapor tolerance	mbar	40	40
Water vapor capacity	l/h	2,6	2,8
Oil capacity	ltr	2	2
Weight	kg	75	75
Admissible ambient temp.	°C	10 to 40	10 to 40
Connection Inlet	G(BSP)	1¼"	1¼"
Outlet	G(BSP)	1¼"	1¼"

Ordering Information	TYPE EV-0100	
	50 Hz	60 Hz
<u>N version (0,5 mbar)</u> <b>Three phase motor</b> 400V, 50Hz (IEC) 400V, 60Hz (IEC)	107.001	107.002
<u>NM version (2 mbar)</u> <b>Three phase motor</b> 400V, 50Hz (IEC) 400V, 60Hz (IEC)	107.101	107.102
<u>L version (20 mbar)</u> <b>Three phase motor</b> 400V, 50Hz (IEC) 400V, 60Hz (IEC)	107.201	107.202
Other Voltages/Frequencies	Upon request	
Filling with special oil	Upon request	
Exhaust filter cartridge	20120A	
Gasket set	20490	
Maintenance kit	20500	
Pump module	20900	
Inlet dust filter, paper cartridge	20800	



## Parts & Accessories



Oil Heater

Oil Cooler

The EV-series vacuum pumps can be equipped with a Oil Heater or Oil Cooling systems.

### **Oil Heater:**

The Oil Heater will be used to warm up the oil before starting the pump in situations where the ambient temperature is below 5°C or to heat the oil around the 75°C to discharge moistures coming into the pump effectively from the start of the pump. The Oil Level Switch will be required for protection against overheating caused by too low oil levels.

It can be installed on the service covers of all pumps from EV-0030 till EV-0750.

### **Oil Cooler:**

The Oil Cooler will be used in situations where the ambient temperature is more than 40°C or when the pump operation temperatures is higher caused by high temperatures of the incoming gasses into the pump. The ball valve on the outlet of the water line can be used set the flow of cooling water to provide appropriate cooling.

It can be installed on the pumps from EV-0160 till EV-0750.

Technical Data		Oil Heater
Supply Power		230V, 50Hz
Power EV-0030 to 0100	kW	1,0
Power EV-0160 to 0300	kW	2,0
Power EV-0450 to 0750	kW	4,0
Length outside housing	mm	140
Diameter housing	mm	90

Ordering Information	Parts & Accessories
Oil Heater EV-0030 to 0100	119.914
Oil Heater EV-0160 to 0300	119.915
Oil Heater EV-0450 to 0750	119.916
Oil Cooler EV-0160 to 0750	119.913

# EV Series accessories

Connection fittings for EV-0030, EV-0045, EV-0065, EV-0100

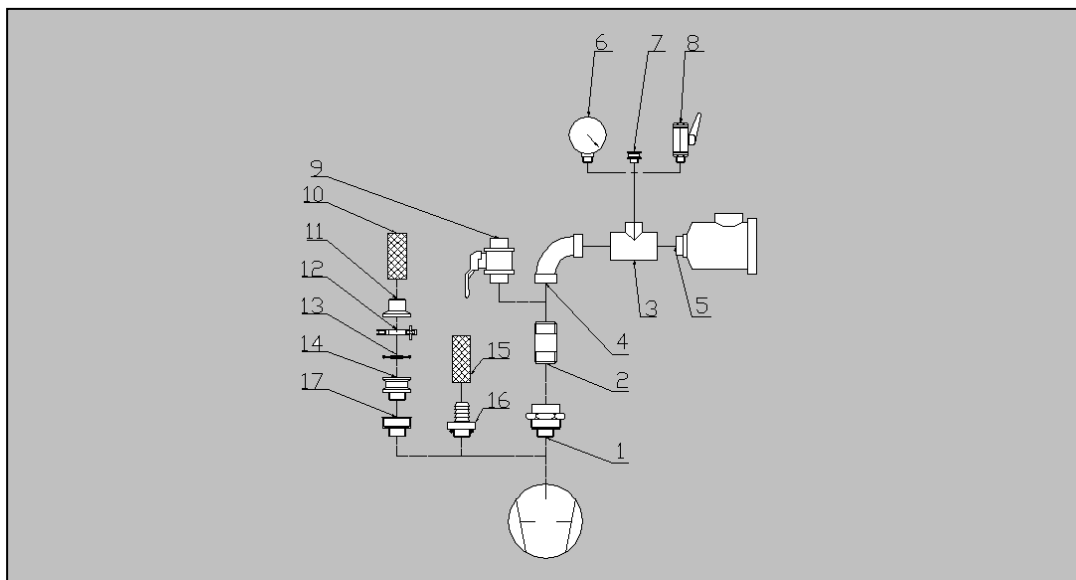

Item	Description	Connection	Ordering No.
1	Rotatable flange	1¼"M-1¼"F	119.101
2	Adapter piece	1¼"M-1¼"M	119.102
	Adapter piece (60mm long)	½"M-½"M	119.120
	Adapter piece (120mm long)	½"M-½"M	119.121
3	T-piece	1¼"F-1¼"F-1¼"F	119.103
	T-piece adapter	1¼"F-½"F-1¼"F	119.117
4	Elbow (short)	1¼"F-1¼"F	119.104
	Elbow (short)	1¼"F-1¼"M	119.105
	Elbow (long)	½"F-½"F	119.118
5	Inlet dust filter, paper cartridge	1¼"M-1¼"F	20.800
6	Manometer 0 to -1 bar	½"M	119.006
7	KF Adapter	½"M-DN16KF	211.367
8	Ball valve	½"M-½"F	119.007
9	Ball valve	1¼"F-1¼"F	119.108
10	Flexible hose	25mm	119.109
11	Hose connection	DN25KF-25mm	211.403
12	Clamping ring	DN25KF	211.002
13	Centering ring	DN25KF	211.061
14	KF Adapter	1"M-DN25KF	211.368
15	Flexible hose	30mm	119.110
16	Hose connection	1¼"M-30mm	119.111
17	Adapter piece	1¼"M-1"F	119.112

# EV Inlet Dust Filters



These dust filters can be mounted on the intake side of the EV-Series vacuum pumps to protect the pump against: dust, powders, chips, etc.

The filters consists of a steel housing with a lit and quick locking clamps.

Quick changing of cartridges is possible and the filters have a high separation ratio.

The housings are suitable to be fitted with four different kind of filters:

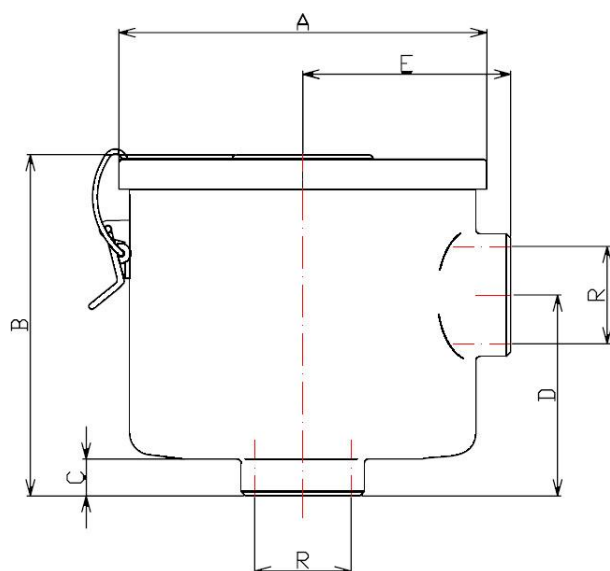

Type	Dimensions in mm						Weight kg
	øR	øA	B	C	D	E	
02.800	G ½"	80	60	12	39	45	0,6
20.800	G 1¼"	170	141	17	93	96	1,8
50.800	G 2"	200	240	18	124	114	3,8
120.800	G 3"	270	180	50	145	165	12,5

## Paper cartridge

Separates particles down to 1 µm. Specially suitable for dry processes. We use this filter as standard.

## Polyester cartridge

Separates particles down to 1 µm. Specially suitable for moist processes.

## Metal cartridge

Separates particles down to 0,08 mm, like pieces of: plastic, paper, food, etc

## Activated charcoal cartridge

Absorbs vapours of high molecular weight, like: acid and solvent vapours, alkaline solutions, etc.

Dust Filter	Housing with paper cartridge	Paper cartridge	Polyester cartridge	Metal cartridge	Activated charcoal cartridge
G ½"	02.800	02.8001	02.8101	02.8201	02.8301
G 1¼"	20.800	20.8001	20.8101	20.8201	20.8301
G 2"	50.800	50.8001	50.8101	50.8201	50.8301
G 3"	120.800	120.8001	120.8101	120.8201	120.8301

# Vacuum Gauge with memory

## EV Vacuum Gauge with memory



Supplied items

System comes in box

The EV Vacuum Gauge with memory solves many problems of vacuum measurements in the production factories and laboratories. The Gauge can be packed inside film or bag of thermoforming and vacuum chamber machines during daily production. It doesn't require stop of production during measurement and allow to verify the well-closing bags and others, thanks to "test" function which measures 99 different vacuum measurements, choosing from 1 to 59 minutes are possible. It stores the values inside its memory and it is possible to read this memory via the USB cable to your computer by using our available software.

Technical Data		Vacuum Gauge with memory	
		1000 to 1 mbar	100 to 0,1 mbar
Dimensions	mm	120x65x25	
Display		4 digit LCD	
Weight	gram	about 300	
Measurement range	mbar	1.000 till 1	100 till 0,1
Max. pressure (failure point)	bar	2	
Temperature	°C	5 to 50	
Accuracy	mbar	± 1	± 0,1
Charge voltage		230 V AC / USB / 5V	
Battery working time		30 hours (rechargeable)	
Application		air and non corrosive gas	
Protection		IP 65	

Ordering Information		Vacuum Gauge with memory	
		1000 to 1 mbar	100 to 0,1 mbar
Complete set of gauge in box		119.900	119.901
Software for computer memory readout		119.902	
16 KF flange to fit the gauge		119.903	

# EV Central Vacuum Systems

EV Central Vacuum Systems for use in factories and hospitals

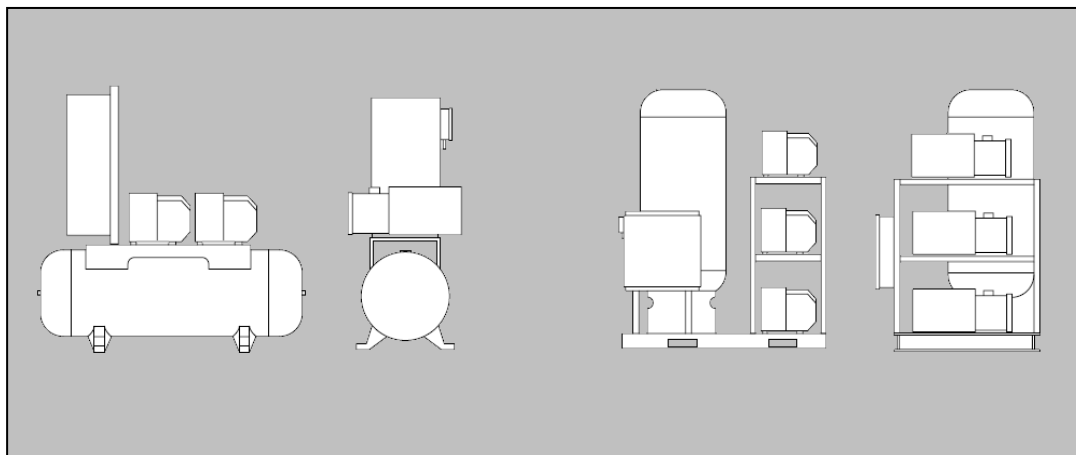

Double system, 2 pumps

Double systems are commonly used in the Industry and offer the advantage of supplying a continuous vacuum more economical than a number of small vacuum units. It also compensates large vacuum variations in the number of vacuum consumers.

Triple system, 3 pumps

Triple systems are commonly used in hospitals and offer the same advantages as the double system. The third pump also offers an extra safety factor for when one of the pumps is switched off by an error or for service purpose. This way there is always a vacuum present, systems are according to DIN EN 737-3

We also have Single systems, 1 pump, available for small systems that need a buffer tank.

At request we will design a special system that meet your requirements.

The following extra options are available from us:

- Dust filters
- Bacterial filters and residue condensate traps
- Pneumatic or electromagnetic blocking valves
- Mobile systems build on wheels
- Stainless steel buffer tank
- Stainless steel piping
- Connections to buildings central control room

The systems are supplied as full assembled and tested, so they are Plug & Play. On your request we can also offer onsite installation and take care of removing your old system when needed.