

TYPE EV-0450

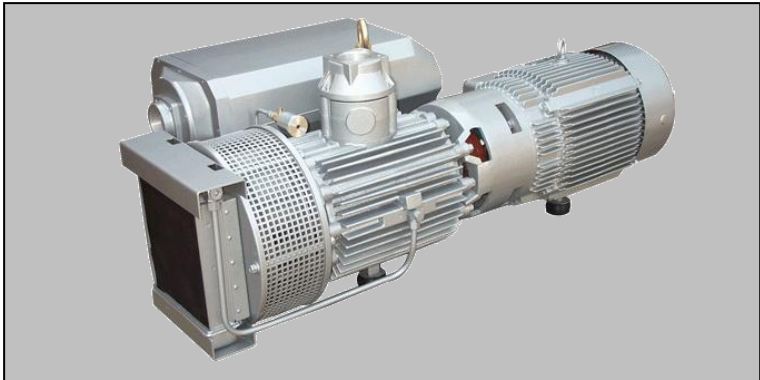

Pumping speed curve

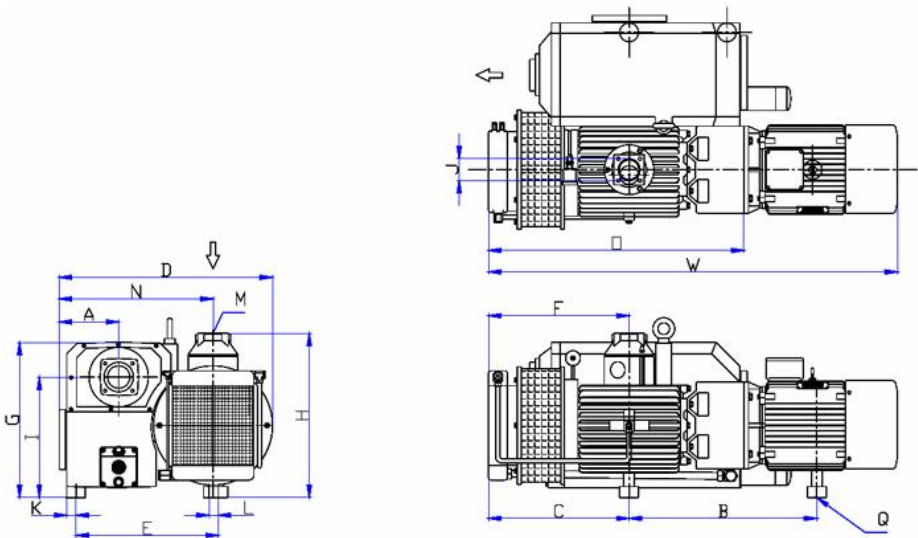
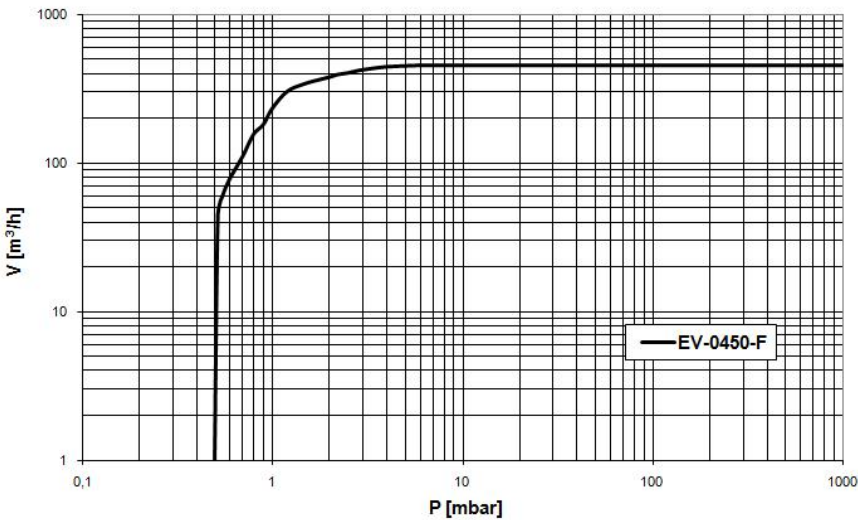

Dimensions	W	D	H	A	B	C	E	F	G	I	J	K	L	M	N	O	Q
EV-0450	1485	860	600	240	649	500	575	500	625	485	G 3"	37	37	G 3"	620	900	3x M12

TYPE EV-0450

Technical Data		TYPE EV-0450	
		50 Hz	60 Hz
Nominal displacement	m ³ /h	448	560
Ultimate pressure F type	mbar	< 0,5	< 0,5
Motor power	kW	11	11
Nominal speed	rpm	980	1160
Noise level	dB(A)	76	78
Operating temperature	°C	80	80
Water vapor tolerance	mbar	40	40
Water vapor capacity	l/h	17	19
Oil capacity	ltr	19	19
Weight	kg	491	504
Admissible ambient temp.	°C	10 to 40	10 to 40
Connection Inlet	G(BSP)	3"	3"
Outlet	G(BSP)	3"	3"

Ordering Information		TYPE EV-0450	
		50 Hz	60 Hz
<u>F version (< 0,5 mbar)</u> Three phase motor 400V, 50Hz (IEC) 400V, 60Hz (IEC)		113.001	113.002
Other Voltages/Frequencies		Upon request	
Filling with special oil		Upon request	
Exhaust filter cartridge		120120A	
Gasket set		120490	
Maintenance kit		080500	
Pump module		080900	
Inlet dust filter, paper cartridge		120800	

TYPE EV-0500

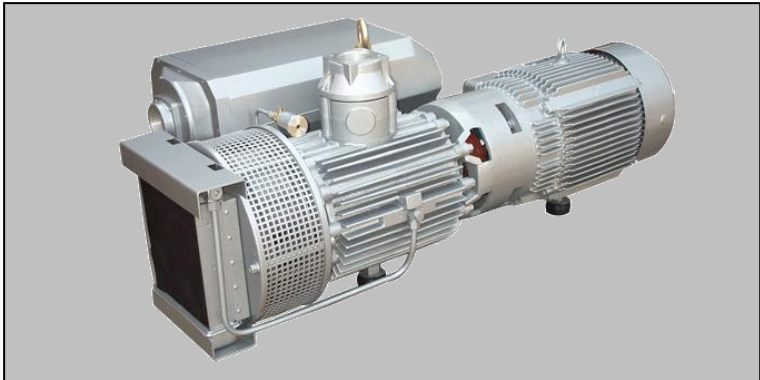

Pumping speed curve

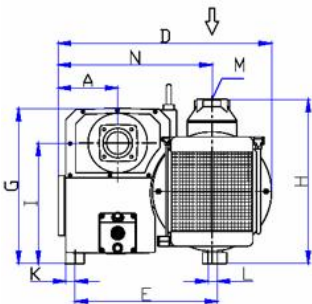
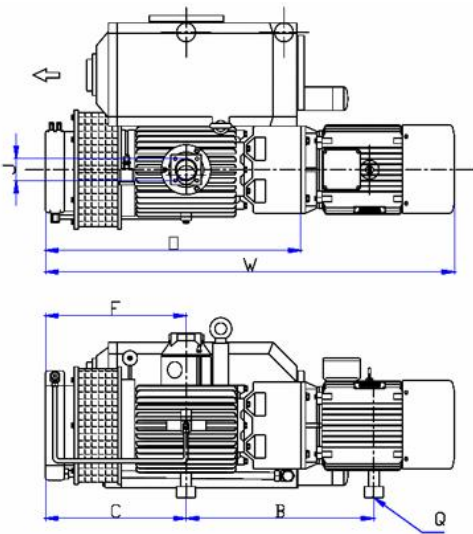
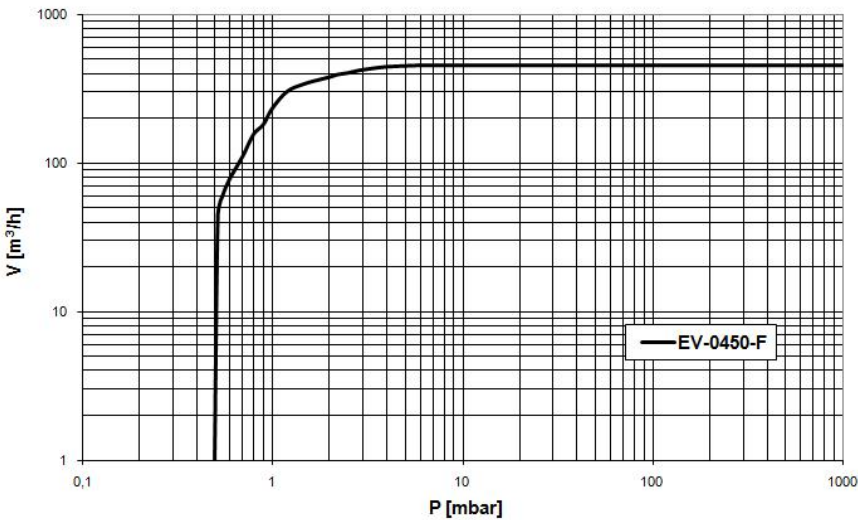

Dimensions	W	D	H	A	B	C	E	F	G	I	J	K	L	M	N	O	Q
EV-0500	1511	860	600	240	649	500	575	500	625	485	G 3"	37	37	G 3"	620	900	3x M12

TYPE EV-0500

Technical Data		TYPE EV-0500	
		50 Hz	60 Hz
Nominal displacement	m ³ /h	500	600
Ultimate pressure F type	mbar	< 0,5	< 0,5
Motor power	kW	11	15
Nominal speed	rpm	980	1160
Noise level	dB(A)	77	79
Operating temperature	°C	82	82
Water vapor tolerance	mbar	40	40
Water vapor capacity	l/h	17	19
Oil capacity	ltr	19	19
Weight	kg	500	520
Admissible ambient temp.	°C	10 to 40	10 to 40
Connection Inlet	G(BSP)	3"	3"
Outlet	G(BSP)	3"	3"

Ordering Information		TYPE EV-0500	
		50 Hz	60 Hz
F version (< 0,5 mbar) Three phase motor 400V, 50Hz (IEC) 400V, 60Hz (IEC)		115.001	115.002
Other Voltages/Frequencies		Upon request	
Filling with special oil		Upon request	
Exhaust filter cartridge		120120A	
Gasket set		100490	
Maintenance kit		100500	
Pump module		100900	
Inlet dust filter, paper cartridge		120800	

TYPE EV-0630

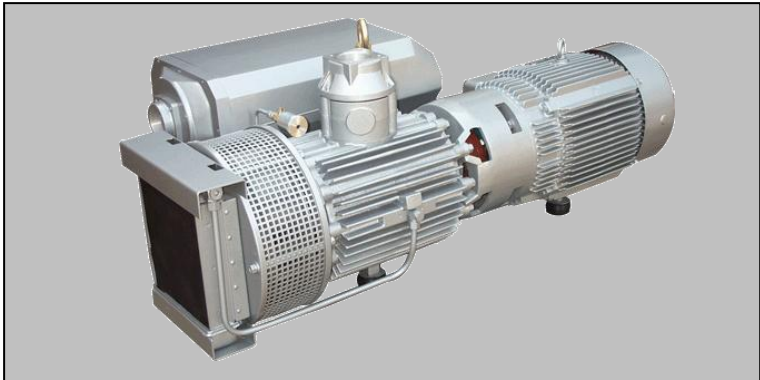

Pumping speed curve

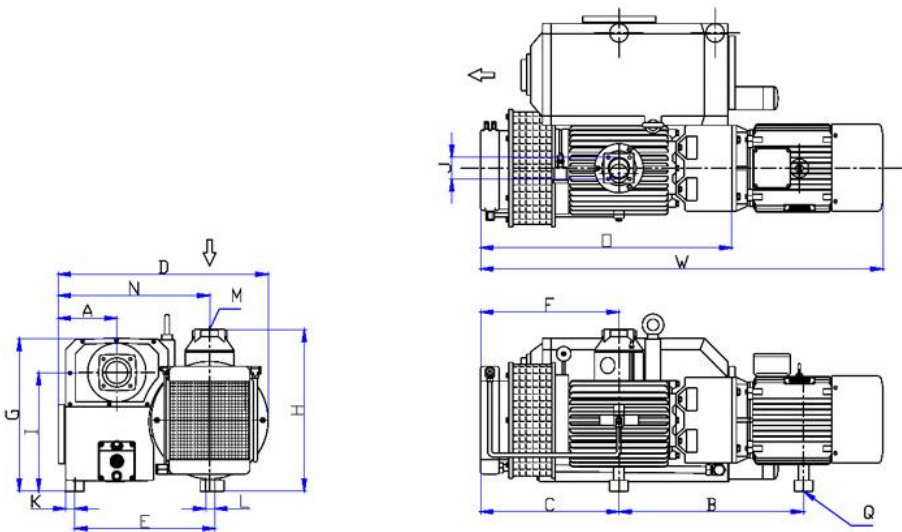
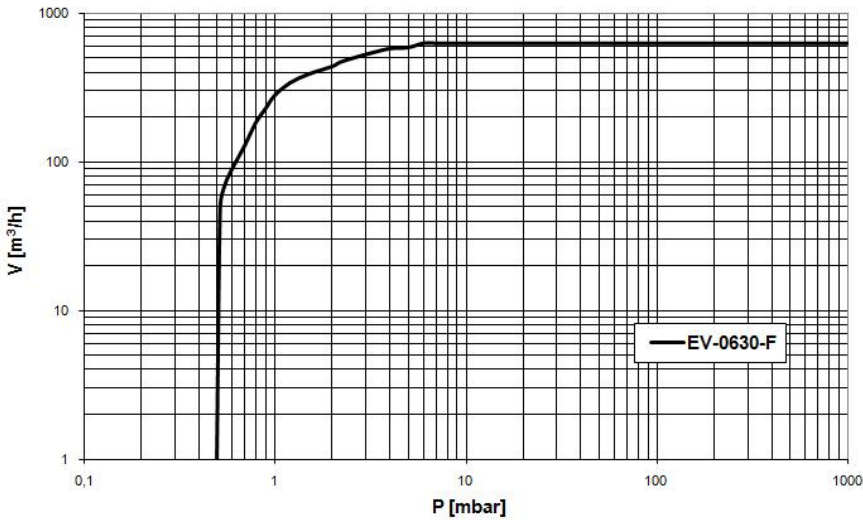

Dimensions	W	D	H	A	B	C	E	F	G	I	J	K	L	M	N	O	Q
EV-0630	1650	860	600	240	757	567	575	567	625	485	G 3"	37	37	G 3"	620	1050	3x M12

TYPE EV-0630

Technical Data		TYPE EV-0630	
		50 Hz	60 Hz
Nominal displacement	m ³ /h	630	780
Ultimate pressure F type	mbar	< 0,5	< 0,5
Motor power	kW	15,0	18,5
Nominal speed	rpm	980	1160
Noise level	dB(A)	77	79
Operating temperature	°C	80	80
Water vapor tolerance	mbar	40	40
Water vapor capacity	l/h	27	30
Oil capacity	ltr	19	19
Weight	kg	582	703
Admissible ambient temp.	°C	10 to 40	10 to 40
Connection Inlet	G(BSP)	3"	3"
Outlet	G(BSP)	3"	3"

Ordering Information		TYPE EV-0630	
		50 Hz	60 Hz
F version (< 0,5 mbar) Three phase motor 400V, 50Hz (IEC) 400V, 60Hz (IEC)		114.001	114.002
Other Voltages/Frequencies		Upon request	
Filling with special oil		Upon request	
Exhaust filter cartridge		120120A	
Gasket set		120490	
Maintenance kit		120500	
Pump module		120900	
Inlet dust filter, paper cartridge		120800	

TYPE EV-0750

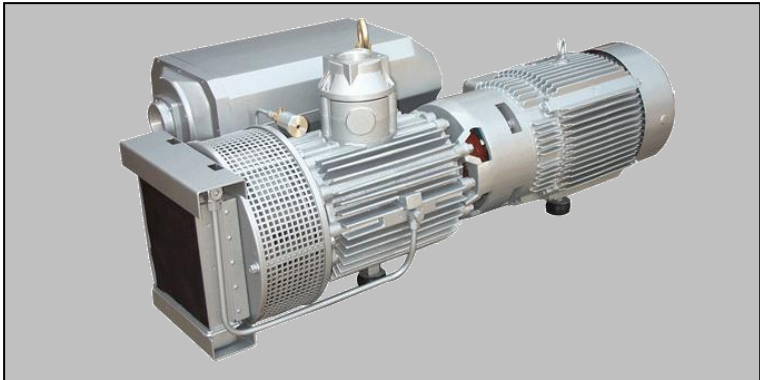

Pumping speed curve

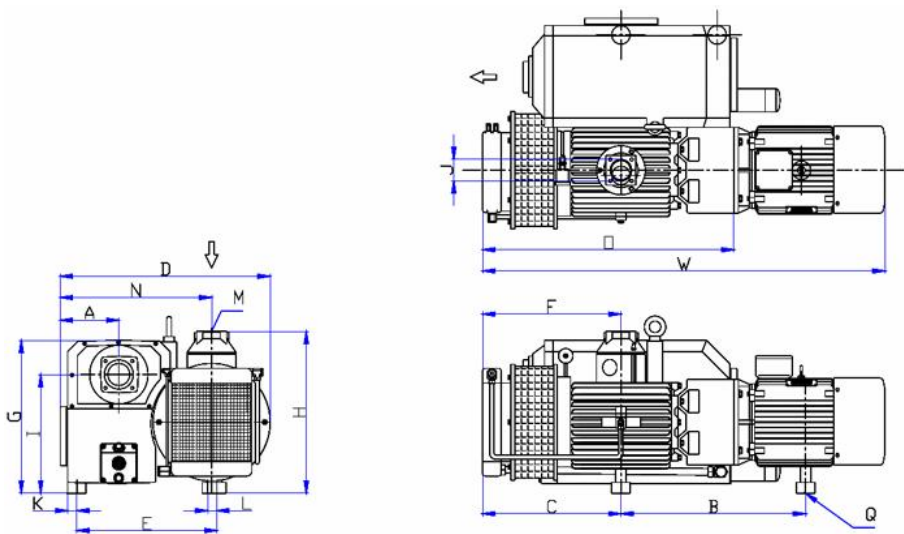
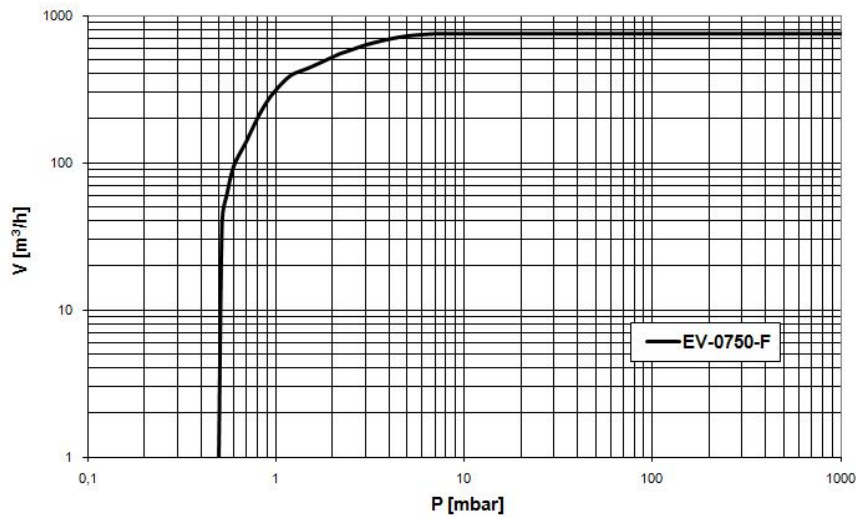

Dimensions	W	D	H	A	B	C	E	F	G	I	J	K	L	M	N	O	Q
EV-0750	1650	860	600	240	757	567	575	567	625	485	G 3"	37	37	G 3"	620	1050	3x M12

TYPE EV-0750

Technical Data		TYPE EV-0750	
		50 Hz	60 Hz
Nominal displacement	m ³ /h	750	
Ultimate pressure F type	mbar	< 0,5	
Motor power	kW	18,5	
Nominal speed	rpm	1500	
Noise level	dB(A)	79	
Operating temperature	°C	80	
Oil capacity	ltr	19	
Weight	kg	600	
Admissible ambient temp.	°C	10 to 40	
Connection Inlet	G(BSP)	3"	
Outlet	G(BSP)	3"	

Ordering Information		TYPE EV-0750	
		50 Hz	60 Hz
F version (< 0,5 mbar) Three phase motor 400V, 50Hz (IEC) 400V, 60Hz (IEC)		116.001	116.002
Other Voltages/Frequencies		Upon request	
Filling with special oil		Upon request	
Exhaust filter cartridge		120120A	
Gasket set		150490	
Maintenance kit		150500	
Pump module		150900	
Inlet dust filter, paper cartridge		120800	

Parts & Accessories



Oil Heater

Oil Cooler

The EV-series vacuum pumps can be equipped with a Oil Heater or Oil Cooling systems.

Oil Heater:

The Oil Heater will be used to warm up the oil before starting the pump in situations where the ambient temperature is below 5°C or to heat the oil around the 75°C to discharge moistures coming into the pump effectively from the start of the pump. The Oil Level Switch will be required for protection against overheating caused by too low oil levels.

It can be installed on the service covers of all pumps from EV-0030 till EV-0750.

Oil Cooler:

The Oil Cooler will be used in situations where the ambient temperature is more than 40°C or when the pump operation temperatures is higher caused by high temperatures of the incoming gasses into the pump. The ball valve on the outlet of the water line can be used set the flow of cooling water to provide appropriate cooling.

It can be installed on the pumps from EV-0160 till EV-0750.

Technical Data		Oil Heater
Supply Power		230V, 50Hz
Power EV-0030 to 0100	kW	1,0
Power EV-0160 to 0300	kW	2,0
Power EV-0450 to 0750	kW	4,0
Length outside housing	mm	140
Diameter housing	mm	90

Ordering Information	Parts & Accessories
Oil Heater EV-0030 to 0100	119.914
Oil Heater EV-0160 to 0300	119.915
Oil Heater EV-0450 to 0750	119.916
Oil Cooler EV-0160 to 0750	119.913

EV Series accessories

Connection fittings for EV-0450, EV-0500, EV-0630, EV-0750

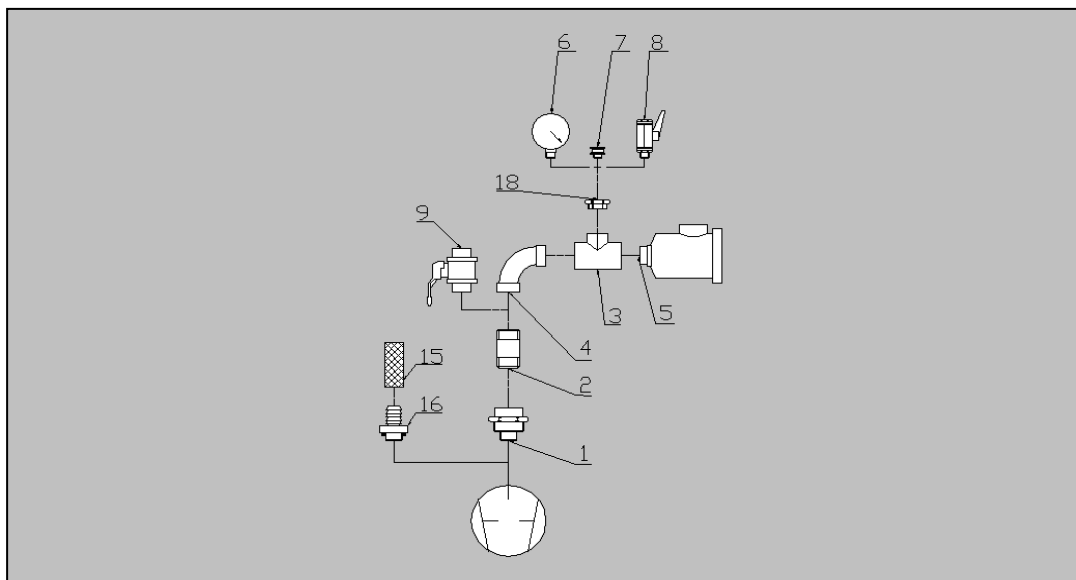

Item	Description	Connection	Ordering No.
1	Rotatable flange	3"M-3"F	119.301
2	Adapter piece	3"M-3"M	119.302
3	T-piece	3"F-2"F-3"F	119.303
4	Elbow	3"F-3"F	119.304
4a	Elbow	3"F-3"M	119.305
5	Inlet dust filter, paper cartridge	3"M-3"F	120.800
6	Manometer 0 to -1 bar	½"M	119.006
7	KF Adapter	½"M-DN16KF	211.367
8	Ball valve	½"M-½"F	119.007
9	Ball valve	3"F-3"F	119.308
15	Flexible hose	76mm	119.310
16	Hose connection	2"M-76mm	119.311
18	Adapter piece	2"M-½"F	119.313

EV Inlet Dust Filters



These dust filters can be mounted on the intake side of the EV-Series vacuum pumps to protect the pump against: dust, powders, chips, etc.

The filters consists of a steel housing with a lit and quick locking clamps.

Quick changing of cartridges is possible and the filters have a high separation ratio.

The housings are suitable to be fitted with four different kind of filters:

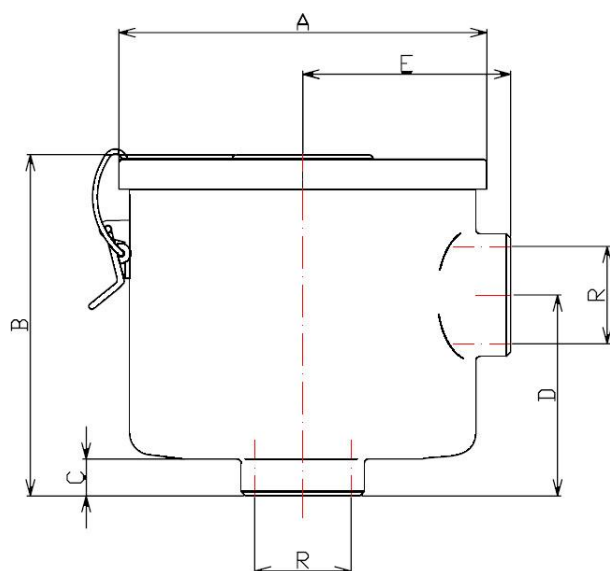

Type	Dimensions in mm						Weight kg
	øR	øA	B	C	D	E	
02.800	G ½"	80	60	12	39	45	0,6
20.800	G 1¼"	170	141	17	93	96	1,8
50.800	G 2"	200	240	18	124	114	3,8
120.800	G 3"	270	180	50	145	165	12,5

Paper cartridge

Separates particles down to 1 µm. Specially suitable for dry processes. We use this filter as standard.

Polyester cartridge

Separates particles down to 1 µm. Specially suitable for moist processes.

Metal cartridge

Separates particles down to 0,08 mm, like pieces of: plastic, paper, food, etc

Activated charcoal cartridge

Absorbs vapours of high molecular weight, like: acid and solvent vapours, alkaline solutions, etc.

Dust Filter	Housing with paper cartridge	Paper cartridge	Polyester cartridge	Metal cartridge	Activated charcoal cartridge
G ½"	02.800	02.8001	02.8101	02.8201	02.8301
G 1¼"	20.800	20.8001	20.8101	20.8201	20.8301
G 2"	50.800	50.8001	50.8101	50.8201	50.8301
G 3"	120.800	120.8001	120.8101	120.8201	120.8301

Vacuum Gauge with memory

EV Vacuum Gauge with memory



Supplied items

System comes in box

The EV Vacuum Gauge with memory solves many problems of vacuum measurements in the production factories and laboratories. The Gauge can be packed inside film or bag of thermoforming and vacuum chamber machines during daily production. It doesn't require stop of production during measurement and allow to verify the well-closing bags and others, thanks to "test" function which measures 99 different vacuum measurements, choosing from 1 to 59 minutes are possible. It stores the values inside its memory and it is possible to read this memory via the USB cable to your computer by using our available software.

Technical Data		Vacuum Gauge with memory	
		1000 to 1 mbar	100 to 0,1 mbar
Dimensions	mm	120x65x25	
Display		4 digit LCD	
Weight	gram	about 300	
Measurement range	mbar	1.000 till 1	100 till 0,1
Max. pressure (failure point)	bar	2	
Temperature	°C	5 to 50	
Accuracy	mbar	± 1	± 0,1
Charge voltage		230 V AC / USB / 5V	
Battery working time		30 hours (rechargeable)	
Application		air and non corrosive gas	
Protection		IP 65	

Ordering Information		Vacuum Gauge with memory	
		1000 to 1 mbar	100 to 0,1 mbar
Complete set of gauge in box		119.900	119.901
Software for computer memory readout		119.902	
16 KF flange to fit the gauge		119.903	

EV Central Vacuum Systems

EV Central Vacuum Systems for use in factories and hospitals

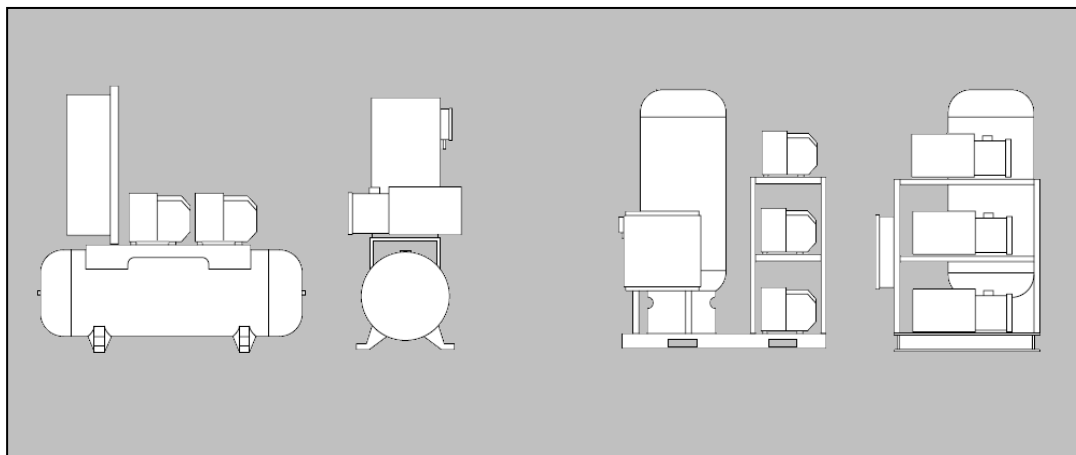

Double system, 2 pumps

Double systems are commonly used in the Industry and offer the advantage of supplying a continuous vacuum more economical than a number of small vacuum units. It also compensates large vacuum variations in the number of vacuum consumers.

Triple system, 3 pumps

Triple systems are commonly used in hospitals and offer the same advantages as the double system. The third pump also offers an extra safety factor for when one of the pumps is switched off by an error or for service purpose. This way there is always a vacuum present, systems are according to DIN EN 737-3

We also have Single systems, 1 pump, available for small systems that need a buffer tank.

At request we will design a special system that meet your requirements.

The following extra options are available from us:

- Dust filters
- Bacterial filters and residue condensate traps
- Pneumatic or electromagnetic blocking valves
- Mobile systems build on wheels
- Stainless steel buffer tank
- Stainless steel piping
- Connections to buildings central control room

The systems are supplied as full assembled and tested, so they are Plug & Play. On your request we can also offer onsite installation and take care of removing your old system when needed.